

GMP CLEANCUBE MINI+



Grade D



Press play for video content



THE CLIENT

Ipsen – they strive to discover, innovate and bring to market pharmaceutical products that will make a difference in the lives of patients, their caregivers and healthcare professionals. With a focus on transformative medicines in oncology, rare disease and neuroscience, Ipsen's vision is to be a leading global mid-size Biopharmaceutical company.



Pharmaceuticals 21+/2C 30m²

THE BRIEF

Ipsen required a Cleancube container laboratory facility to replace their existing Grade D lab. Because space was at a premium at their premises in Wrexham, the Cleancube Mini+ would need to be located adjacent to their host building in an outside paved area, providing QC incoming sample testing.



“The perfect choice...”

Guardtech Group Project Manager Elliott Pearce said: “We’re always delighted to find new and innovative ways to solve problems for a client. Cleancube has afforded us this opportunity on many occasions over the past few years and this project is another great example of the application’s flexibility. “Ipsen wanted a new Grade D space but were limited by the restrictions of their host building. What they did have, was a small exterior space where a modular solution could sit. Even then, the shape of the space meant that only certain types of solution would be applicable – which is why a Cleancube Mini+, or two 20ft containers conjoined to create a single 30sqm square unit, was the perfect choice.”

Elliott Pearce
Guardtech Group
Project Manager



cleancube
mobile cleanrooms

GMP CLEANCUBE MINI+



Press play for video content



THE TECH SPECS

A controlled environment designed, installed, cleaned and commissioned by Guardtech built to the following specification:

◆ **Structural:** GT Shell Pro semi-flush de-ended wall panel system, air return panels hollow core and low level exhaust grille for transit back to duct spigot, GT Lid Pro ceiling panel system, GT Deck Plus flooring with pre-formed cove, wall to floor, laid under vinyl, 100mm FFL to underside of panel face, GT Access Plus semi-flush single and double doors, emergency exit door, Jackpad levelling legs and pads, GT Vision Plus 900mm x 900mm fish tank double glazed units.

◆ **Electrical:** GT Lux Pro 1,200mm x 600mm recessed LED luminaires delivering 500 lux as standard – DALI2 Circadian Rhythm programmable LED lighting System, GT Lux Tear baton lighting in Plant Room, electromagnetic interlocks and status indicators, emergency break glass, traffic lights, 13amp double sockets in three-compartment dado trunking, CAT6 data sockets in 3-compartment

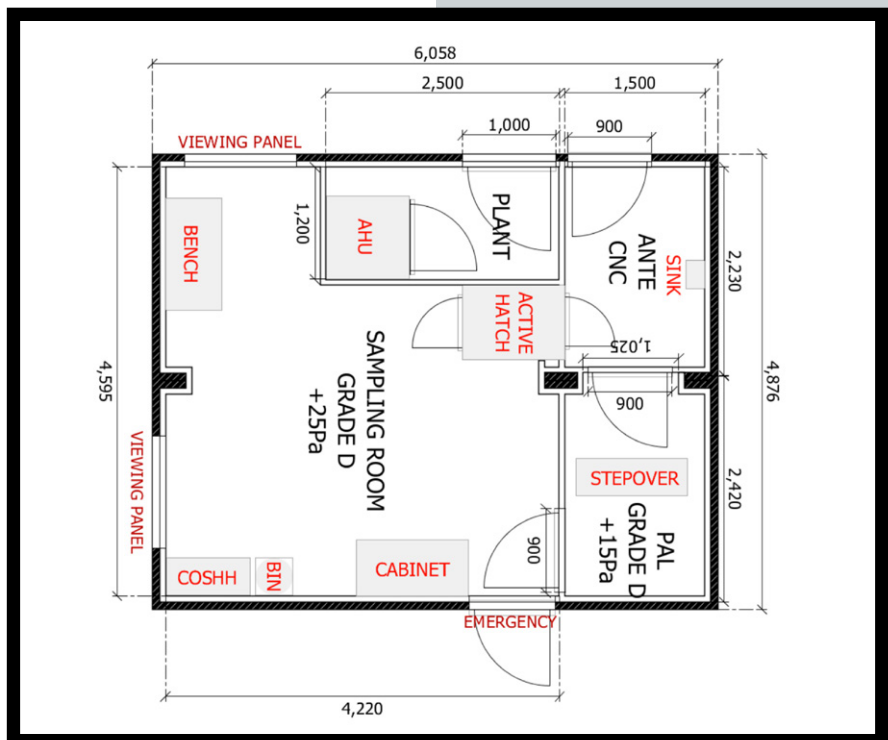

dado trunking, smoke detection heads and fire alarm panel, distribution board, 3-phase power outlet.

◆ **Mechanical:** GT Air Plus Air Handling Unit (AHU) provided via Upflow close control unit located in Plant Room – total cooling capacity

of 16kW, GT Flow Plus H14 HEPA Fan Filter Units with roomside change.

◆ **Monitoring:** GT Scan Helix magneto-helic gauge environmental monitoring measuring pressure.

Continued on next page

GMP CLEANCUBE MINI+



◆ **Furniture & Equipment:** Grade 316 stainless steel sink, Dyson airblade hand dryer, grade 316 stainless steel steptover bench, grade 316 stainless steel active trolley hatch, grade 316 stainless steel workbench, grade 316 stainless steel COSHH cabinet, grade 304 stainless steel bin, grade 316 stainless steel cabinet.

THE CHALLENGES

Given the Cleancube team's vast experience of dealing with much larger-scale shipping container cleanroom facilities, this relatively modest Mini+ was a fairly straightforward installation – conducted on time and on budget.

There were, however, a few minor challenges that the team overcame during the build.

Tight squeeze: The external space that had been allocated for the Cleancube Mini+ was extremely tight. This meant that craning the two separate 20ft modules into position required all our experience and skill. Having positioned similarly tight Cleancubes for the likes



of Cambridge Clinical Laboratories (where a CL3 lab was stationed with less than a metre either side of clearance), this tricky task was made a lot easier for the loader crane operative.

Fully loaded: The Design and Installation Teams worked together brilliantly to pack a significant amount of cleanroom hardware

into a relatively small footprint – which boasts a pre-change zone, change area and main process room with an active trolley hatch. This also included a fire alarm system, gas detection, COSHH cabinet, storage cabinet sink and workbench. A strong example of how the Cleancube team, and wider Guardtech Group, do everything they can to ensure every need possible is met for clients.

GMP CLEANCUBE MINI+

Contact Us



Guardian House
Unit 1A Homefield Road,
Haverhill, CB9 8QP

0330 113 0303

sales@guardtech.com

www.guardtechgroup.com



Press play for
video content



THE RESULT

Guardtech Group Project Manager Elliott Pearce said: "At the Guardtech Group, we're always delighted to find new and innovative ways to solve problems for a client. Cleancube has afforded us this opportunity on many occasions over the past few years and this project is another great example of the application's flexibility. "Ipsen wanted a new Grade D space but were limited by

the restrictions of their host building. What they did have, was a small exterior space where a modular solution could sit. Even then, the shape of the space meant that only certain types of solution would be applicable – which is why a Cleancube Mini+, or two 20ft containers conjoined to create a single 30sqm square unit, was the perfect choice. "To cram a world-class GMP lab into such a footprint is just another indication of why Cleancube has become such a gem in the crown of the Guardtech Group portfolio."

